

# SCANNEXUS

## Gasketed Safety Glasses

You have chosen a Scandia Gear Personal Protective Equipment. Please read these instructions prior to use and prior to any maintenance.

### European EN 166:2001 standard

**EN 166:2001 : European standard for personal eye-protection**

This CE certified safety spectacles belongs to Category II and is approved in accordance with the Regulation (EU) 2016/425 and the requirements of the European harmonized standard EN166:2001. This product has been subjected to a CE-type Examination performed by:

INSPEC International B.V. N.B.2849  
Beechavenue 54-62  
1119 PW Schiphol-Rijk  
The Netherlands

The PPE is designed to provide the user with adequate protection. The rating of the PPE is indicated by markings and related indexes on the frame and lenses. The rating is obtained from tests in which the prototypes were submitted.

The EU Declaration of Conformity (DOC) can be found at the Scandia Gear website ([www.scandiegear.com](http://www.scandiegear.com)), under the Scandia product name ScanNexus and through the link "Declaration of Conformity".

### Application and limitations

Please ensure that the eyewear always fits well. The main purpose of this safety eyewear is to provide the user a limited impact resistance. It may not be suitable for certain environment, such as under a liquid splash or low light surroundings. These spectacles are intended for the following purposes:

- A) Use in factories, on construction sites, in mining operations, and other worksites where basic eye protection (i.e., particle impact speed under 45 m/s) is required.
- B) DIY activities, such as gardening and furniture construction and repair.

### Adjusting the Gasket

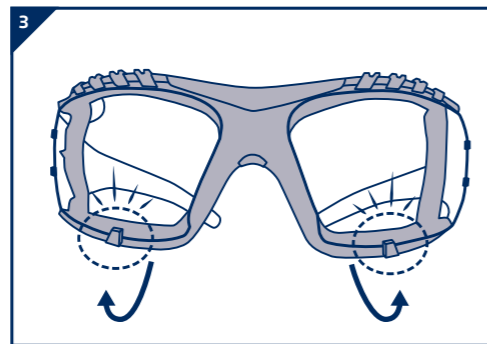
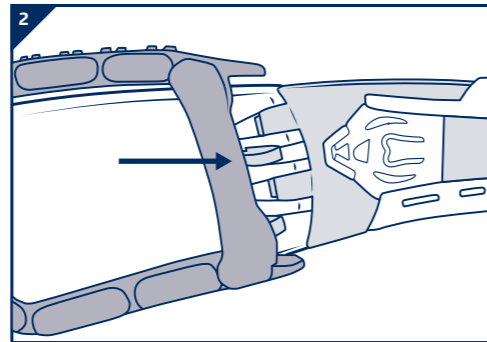
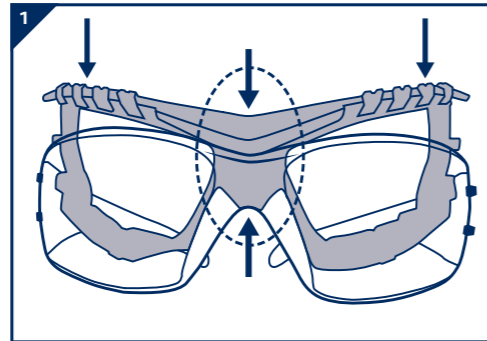

### Adjusting the Temples

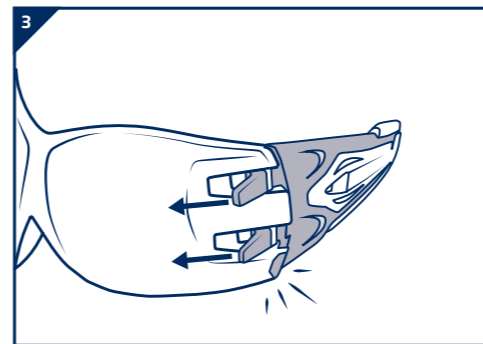
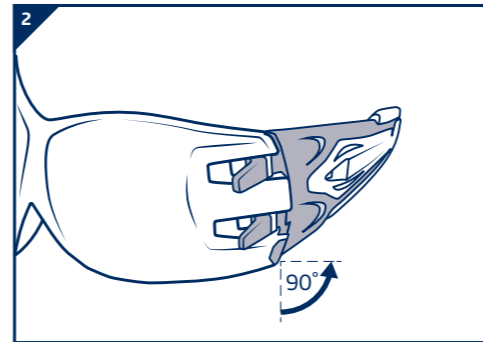
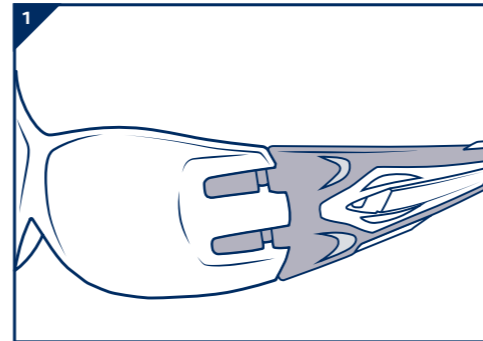

### Adjusting the Strap

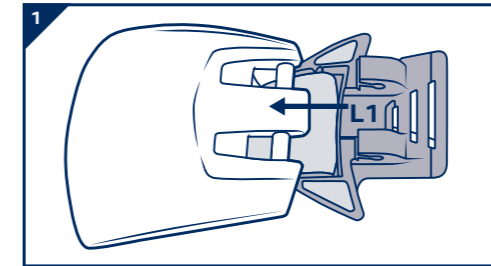

To ensure the strap is attached correctly, please refer to the markings (L = left side, R = right side) inside the buckle (fig.7).

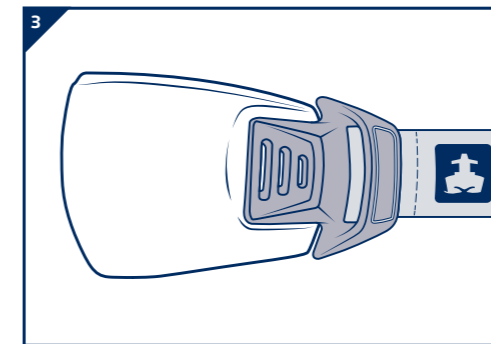
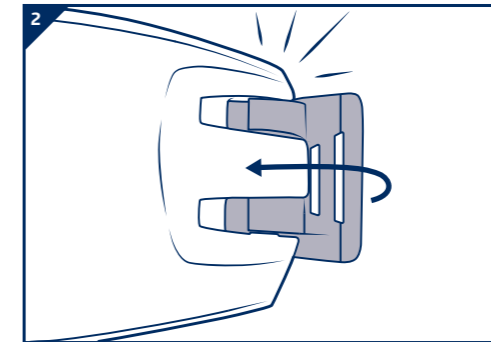

### Model

The name of the model is always indicated on the barcode of the packaging.

### Storage

Store in a dry place at room temperature and protect from sunlight. The eyewear must be transported and stored in the original package, at a temperature between 5°C and 40°C (41°F and 104°F) and a relative humidity of <90%.

### Maintenance

The lenses must be cleaned or disinfected regularly. This must be done using a mild detergent, optical cleaning solution, or a solution very low in alcohol at room temperature (20°C/68°F ± 5°C/41°F). The eyewear should provide adequate protection for a period exceeding 6 months and up to 2 years. Regularly check the status. Scratched or damaged lenses must be replaced or disposed of. The markings found on the lens and on the frame represent the ratings of the product. Scandia Gear shall not be liable for damages arising from misuse and improper maintenance and preservation of the PPE itself.

### Validity

The product is valid for three (3) years after the manufacturing date displayed on the temples.

### Lens markings

Scale number (filters only) – Identification of Manufacturer – Optical class – symbol of mechanical resistance – Field (s) of use (if applicable) CE Marking.

### Frame markings

Identification of the manufacturer – Number of EN standards – Field (s) of use (if applicable) – Mechanical resistance – CE Marking.

Scale number (filters only)		
Type of filter	Code number	Filter rating number
EN 169 Welding filters	No code number	1 to 16
EN 170 Ultraviolet (UV) filters	2	1,2 to 5
EN 170 Ultraviolet (UV) filters with good color recognition	2C	1,2 to 5
EN 171 Infra-red (IR) filters	4	1,2 to 10
EN 172 Solar protection filters without infra-red specification	5	1,1 to 4,1
EN 172 Solar protection filters with infra-red specification	6	1,1 to 4,1

Optical Class	
Code	Designation
1	Optical Class
2	Intermittent work
3	Occasional work (not intended for prolonged use)

Mechanical resistance	
Code	Mechanical Strength Requirements
No symbol	Minimum robustness
S	Increased robustness (5.1 m/s)
F	Low energy impact (45 m/s)
B	Medium energy impact (120 m/s)
A	High energy impact (190 m/s)

If the symbol F, B or A is not found on both the lenses and the frame, then the lower value is assigned to the complete set of safety glasses. The letter T immediately after the impact letter allows a use for high speed particles at extremes of temperature. In the absence of the letter T the protector must be used in room temperature.

Marking on lens	
Code	Designation
K	Resistance to surface damage caused by fine particles
N	Resistance to fogging

Fields of use		
Code	Designation	Description of the field of application
No symbol	Basic	Unspecified mechanical hazards and dangers from ultraviolet, visible, infra-red and solar radiation
3	Liquids	Liquids (droplets and splashes)
4	Large dust particles	Dust with a particle size > 5 µm
5	Gas particles and fine powder	Gases, vapours, sprays, smoke and dust with a particle size <5 µm
8	Short circuit electric arc	Short circuit electric arc in electrical devices
9	Molten metal and hot solids	Splashes of molten metal and the penetration of hot solids

Welding filters			
Scale	Field of use	Gas	l/h
1,7	Welders assistants	-	-
3	Assistant welder	-	-
4	Braze welding	Acetylene	<70
5	Braze welding	Acetylene	70:200
	Oxy-fuel welding and cutting	Oxygen	900:2000
6	Braze welding	Acetylene	200:800
	Oxy-fuel welding and cutting	Oxygen	2000:4000

## Warning

- Eye protection that is worn over standard ophthalmic spectacles may transmit impact from high speed particles thus creating a hazard to the wearer. Although every effort is made to ensure that materials that may come into contact with the skin of the wearer do not cause an allergic reaction, this may not happen for a minority of susceptible individuals, and if you are in this situation, you must stop wearing the eyewear immediately and seek professional advice.

- These spectacles are intended for use as work site eye protection. They should not be used as protective equipment in sports or in hazardous recreational activities.
- Do not use these spectacles for protection when driving, especially in the night time. These spectacles do not provide protection against laser lights and direct sunlight.
- These spectacles should not be used as personal protective equipment for welding, electrical maintenance, grinding, food preparation or heavy industrial work.

## Manufacturer

Scandia Gear Europe B.V.  
Lorentzweg 31  
3208 LJ Spijkennisse  
The Netherlands

## Disclaimer

Scandia Gear is not liable for damages that result from the improper use of these products.



SCANDIA GEAR EUROPE B.V.  
 📍 Lorentzweg 31, 3208 LJ Spijkennisse, The Netherlands  
 📞 +31 (0)181 600 955 📠 +31 (0)181 600 966  
 ✉ info@scandiegear.com 🌐 www.scandiegear.com

# SCANNEXUS

Gasketed Safety Glasses

User's Instruction

www.scandiegear.com

ROTTERDAM SINGAPORE HOUSTON DUBAI

SINCE 1974  
MARITIME OUTFITTERS

Scandia®