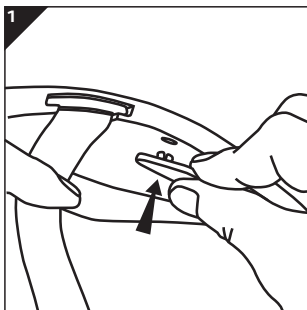
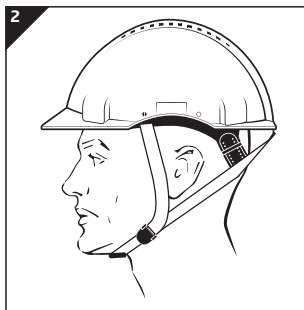

**1. Install ScanTristrap**

Insert the three chin strap pins into the helmet holes. Firmly press the pins until you hear a click. Adjust the chin strap to fit the wearers head correctly. It is important that the chin strap is properly tensioned in their attachments.

**2. Correct fit**

The helmet should first be balanced and the helmet suspension cradle adjusted to fit the wearers head.

**3. Position the strap**

To adjust the position of the strap, open the cam-lock buckles. Once the correct fitment is achieved, close the cam-lock buckles.

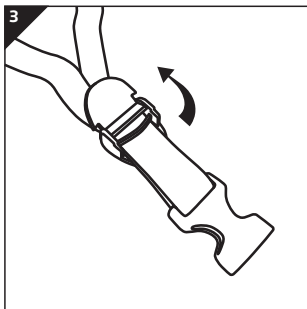
**4. Adjust the strap**

Adjust the strap on both sides on the helmet to ensure a secure fit underneath the chin and the ears are not obstructed.

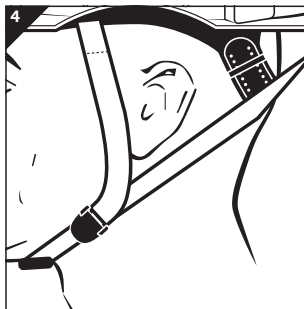
[www.scandiegear.com](http://www.scandiegear.com)
**1. Install ScanTristrap**

Insert the three chin strap pins into the helmet holes. Firmly press the pins until you hear a click. Adjust the chin strap to fit the wearers head correctly. It is important that the chin strap is properly tensioned in their attachments.

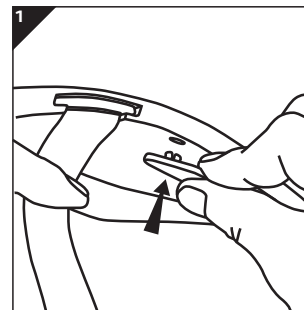
**2. Correct fit**

The helmet should first be balanced and the helmet suspension cradle adjusted to fit the wearers head.

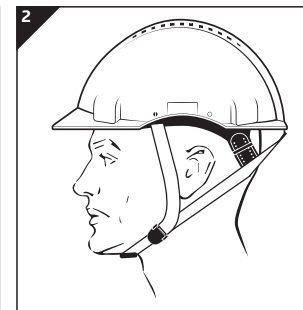
**3. Position the strap**

To adjust the position of the strap, open the cam-lock buckles. Once the correct fitment is achieved, close the cam-lock buckles.

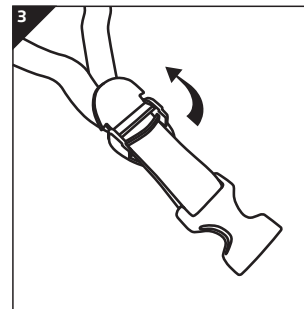
**4. Adjust the strap**

Adjust the strap on both sides on the helmet to ensure a secure fit underneath the chin and the ears are not obstructed.

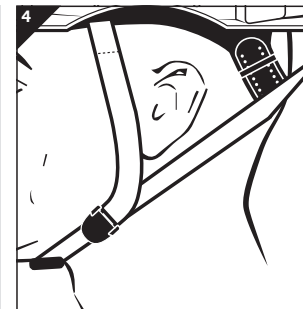
[www.scandiegear.com](http://www.scandiegear.com)
**1. Install ScanTristrap**

Insert the three chin strap pins into the helmet holes. Firmly press the pins until you hear a click. Adjust the chin strap to fit the wearers head correctly. It is important that the chin strap is properly tensioned in their attachments.

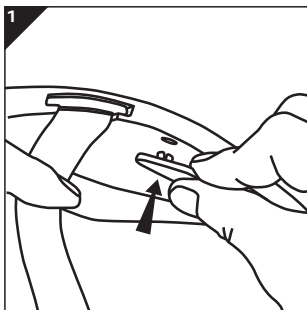
**2. Correct fit**

The helmet should first be balanced and the helmet suspension cradle adjusted to fit the wearers head.

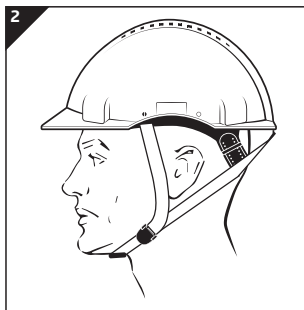
**3. Position the strap**

To adjust the position of the strap, open the cam-lock buckles. Once the correct fitment is achieved, close the cam-lock buckles.

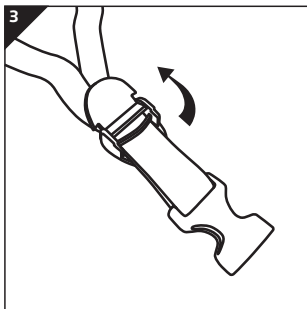
**4. Adjust the strap**

Adjust the strap on both sides on the helmet to ensure a secure fit underneath the chin and the ears are not obstructed.

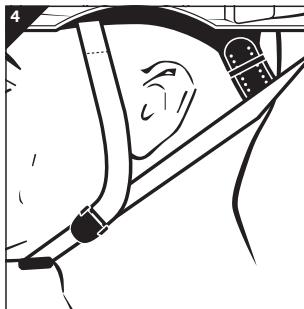
[www.scandiegear.com](http://www.scandiegear.com)
**1. Install ScanTristrap**

Insert the three chin strap pins into the helmet holes. Firmly press the pins until you hear a click. Adjust the chin strap to fit the wearers head correctly. It is important that the chin strap is properly tensioned in their attachments.

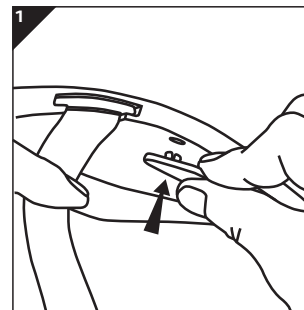
**2. Correct fit**

The helmet should first be balanced and the helmet suspension cradle adjusted to fit the wearers head.

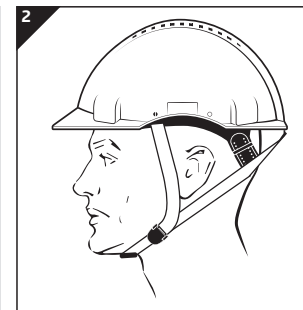
**3. Position the strap**

To adjust the position of the strap, open the cam-lock buckles. Once the correct fitment is achieved, close the cam-lock buckles.

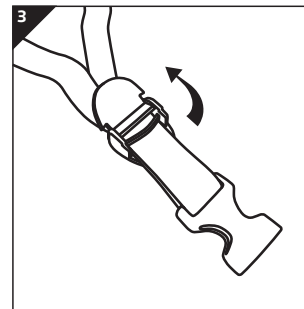
**4. Adjust the strap**

Adjust the strap on both sides on the helmet to ensure a secure fit underneath the chin and the ears are not obstructed.

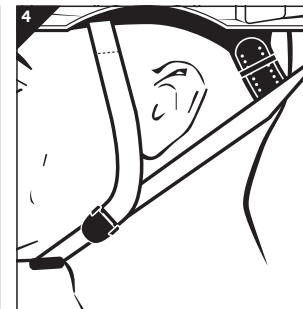
[www.scandiegear.com](http://www.scandiegear.com)