

# HALF MASK RESPIRATOR

This respirator helps protect against certain particles. **Misuse may result in sickness or death.** For proper use, see supervisor, instructions or contact us.

## Important

Before use, the wearer must read and understand these user instructions. Keep insert for reference.

## Use for

Solids such as those from processing minerals, coal, iron ore, flour and certain other substances. Liquid or non-oil based particles from sprays that do not also emit oil aerosols or vapours.

## Do not use for

Paint spray, oil aerosols, gases, vapors, asbestos or sandblasting. This respirator does not supply oxygen.

## Use instructions

- Failure to follow all instructions and limitations concerning the use of the respirator and/or failure to wear the respirator for the whole duration of exposure to contaminants can seriously reduce the performance characteristics of the respirator and lead to illness, injury or death.
- Before use, the wearer must first be trained by the employer in the correct use of the respirator in accordance with applicable safety and health standards.
- OSHA standards including 29 CFR 1910.134(e) (5) and CSA standard Z94.4-93 require that the wearer be fit-tested. Before occupational use of this respirator a written respiratory protection program must be implemented meeting all the local government requirements. In the United States employers must comply with OSHA 29 CFR 1910.134 which includes medical evaluation, training, and fit testing.
- Discard the respirator and replace with a new one if:
  - Excessive clogging of the respirator causes breathing difficulty.
  - The respirator becomes damaged.
- Leave the contaminated area if dizziness,
- Irritation or other distress occurs.

## Use limitations

- Do NOT use the respirator or enter or stay in a contaminated area under the following circumstances:
  - Atmosphere contains less than 19.5% oxygen.
  - Atmosphere contains oil aerosols if using N protection class respirator
  - For protection against gases or vapors
  - Contaminants or their concentrations are unknown or immediately dangerous to life or health
  - Concentrations or contaminants exceed maximum use concentrations in applicable OSHA standards or applicable government regulations or 10 times the PEL (Permissible Exposure Limit), whichever is lower
  - For sandblasting, paint-spray operations, asbestos
- Do NOT modify or misuse the respirator.
- Do NOT use the respirator with beards or other facial hair that interferes with direct contact between the face and the edge of the respirator, or any other conditions that may prevent a good face-seal.

## Warning

This respirator helps protect against certain contaminants. It may not eliminate the risk of contracting disease or infection. Misuse may result in sickness or death. Materials which may come into contact with the wearer's skin could cause allergic reactions to susceptible individuals.

FOR MORE INFORMATION or assistance please contact with Scandia Gear.

## Fitting instructions

Follow these instructions each time respirator is worn.

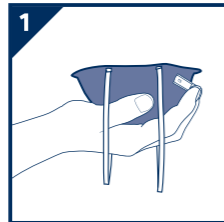

**1.** Hold the respirator in one hand with the nose-piece at your fingertips, allowing the headbands to hang below your hand.



**2.** Press the respirator against your face with the nosepiece on the bridge of your nose.



**3.** Place the top band high on the back of your head. Move the bottom band over your head and position it below your ears.



**4.** Using both hands, mould the nosepiece to the shape of your nose.



**5.** Test the fit. Cup both hands over the respirator and exhale vigorously. If air flows around your nose, tighten the nosepiece. If air leaks around the edges, reposition the bands for better fit.



**6.** Fit-check the face-seal as follows:
 

- Place both hands over the respirator without disturbing its position.
- If the respirator is not fitted with an exhalation valve, exhale sharply.
- If the respirator is fitted with an exhalation valve, inhale sharply (a negative pressure should be felt inside the respirator).

- If you detect air-leaks, re-adjust the head straps and/or the position.

## Removal instructions

See step 3 of fitting instructions and cup respirator in hand to maintain position on face. Pull bottom strap overhead. Still holding respirator in position, pull top strap overhead and remove respirator. This respirator contains no components made from natural rubber latex.

## NIOSH-approved: N95



SCANDIA GEAR EUROPE B.V.  
 Lorentzweg 31, 3208 LJ Spijkenisse, The Netherlands  
 +31 (0)181 600 955 +31 (0)181 600 966



The respirator is approved only in the following configurations:

TC (Technical Certificate)	Protection (1)	Respirator	Cautions and limitations (2)
		ScanRespi FFP2-V	
TC-84A-7866	N95	X	A B C J M N O P S *

## 1. Protection

**N95** - Particulate Filter (95% filter efficiency level) Effective against particulate aerosols free of oil, time use restrictions may apply.

## 2. Cautions and limitations

- A.** Not for use in atmospheres containing less than 19,5% oxygen.
- B.** Not for use in atmospheres immediately dangerous to life or health.
- C.** Do not exceed maximum use concentrations established by regulatory standards.
- J.** Failure to properly use and maintain this product could result in injury or death.
- M.** All approved respirators shall be selected, fitted, used, and maintained in accordance with MSHA, OSHA and other applicable regulations.
- N.** Never substitute, modify, add, or omit parts. Use only exact replacement parts in the configuration as specified by Scandia Gear.
- O.** Refer to User's Instructions and/or maintenance of these respirators.
- P.** NIOSH does not evaluate respirators for use as surgical mask.
- S.** Special or critical User's Instructions and/or specific use limitations apply. Refer to User's Instructions before donning.

\* "S" Special or Critical User Instructions - The models ScanRespi FFP2-V filtering face piece respirators were manufactured by Suzhou Fangtian Industries Co., Ltd for Scandia Gear Europe B.V. under TC-84A-7866.

## Disclaimer

Scandia Gear is not liable for damages that result from the improper use of these products.

Made with 100% recycled paper

SCANDIA GEAR EUROPE B.V.  
 Lorentzweg 31, 3208 LJ Spijkenisse, The Netherlands  
 +31 (0)181 600 955 +31 (0)181 600 966  
 info@scandiegear.com www.scandiegear.com

# HALF MASK RESPIRATOR

## Reference

- ScanRespi FFP1 NR without valve
- ScanRespi FFP2-V NR with valve
- ScanRespi FFP3-V NR with valve

The EU Declaration of Conformity (DOC) can be found at the Scandia Gear website ([www.scandiegear.com](http://www.scandiegear.com)), under the Scandia product name ScanRespi FFP1, ScanRespi FFP2-V, ScanRespi FFP3-V and through the link "Declaration of Conformity".

## Purpose

Half mask respirators are suitable for use only as protection against nonvolatile solid and liquid particles (Dust, smoke, aerosols, aerosol vapor, see Table 1 for Assigned Protection Factors).

## Conditions for Use

- Failure to comply with these instructions and the information contained herein presents a health risk and can lead to irreversible damage.
- You must understand how to wear and maintain this mask before using it.
- The volume of oxygen in your workspace must be at least 19.5%.
- Half mask respirators do not provide sufficient protection in non-aerated containers, excavations, ducts, restricted work areas, and during work involving abrasive blasting.
- Beware of the nature and concentration of hazardous substances stored or being used in your workspace before you begin work in that workspace while wearing this mask.
- Half mask respirators do not protect against gases and vapors.
- Change your mask if you have difficulty inhaling and exhaling while wearing it.
- Replace this mask after 8 hours of use.
- Facial hair or obstructions along the perimeter of the mask can compromise the mask's effectiveness.

## Table 1 – Assigned Protection Factor (APF)

Overall protections are indicated by an APF value, which measures the concentration of contaminant outside the

respiratory protection device against that inside the respiratory protection device. For example, if a half mask respirator has a protection factor of 10, the mask provides protection in atmospheres in which the concentration of contaminants is 10 times higher than that contaminant's permissible exposure limit (PEL).

## Important

Allocated protection factors, workplace concentration, and target concentration levels may differ from country to country.

## Use

Choose respiratory protection suitable for the hazards you will encounter in your workspace.

Device Class	Assigned Protection Factor (APF)	Filter penetration limit (at 95 L/min air flow)	Inward leakage	Comments, restrictions
Half mask respirator ScanRespi FFP1	4	Filters at least 80% of airborne particles	<22%	Does not protect against radio-active substances, and microorganisms (e.g., viruses, bacteria, and fungi)
Half mask respirator ScanRespi FFP2-V	10	Filters at least 94% of airborne particles	<8%	Does not protect against radio-active particles, viruses, and enzymes
Half mask respirator ScanRespi FFP3-V	20	Filters at least 98% of airborne particles	<2%	

If you are unsure, ask a qualified person for assistance. If you are suffering from an illness, consult a physician about the reliability of respiratory protection. Comply with Scandia Gear's instructions concerning the wear and use of this mask. Before use, check the mask's expiration date (see details on packaging). Do not use a mask that is damaged or soiled.

This is a single use mask that must be replaced after 8 hours of use.

This product contains no components made from natural rubber latex.

## Storage

Store this mask in areas that are dry, cool, and free of hazardous substances. The temperature in these areas must be between -30°C (-22°F) and +70°C (158°F) and the atmospheric humidity < 80%. Before use, keep the mask in its original packaging and away from direct sunlight. Under these conditions the mask's shelf life is 5 years.

## Pictogram

- A. Permitted storage temperature range
- B. Maximum relative humidity for storage
- C. See info user's manual
- D. Expiration date : mm=Month, yyyy=Year

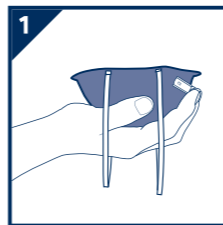

1. Hold the mask in your hand with the nosepiece facing up. Allow the mask's headbands to hang freely.



2. Position the mask under your chin so that it covers your mouth and nose. Pull the top headband around your head, placing the band above your ears.



3. Pull the bottom headband around your head, placing the band above your ears.



4. Shape the nosepiece around your nose to create a secure and comfortable fit.



5. To test the effectiveness of the mask's fit, cup your hands, place them over the mask, and exhale vigorously. Your breath should flow through the mask, not outside it.

If you can feel your breath around the mask's edges, reshape the nosepiece and reposition the headbands.



6. Retest the effectiveness of the mask's seal throughout occupational use.

## Limits on Use

- Leave your workspace immediately if:
- You have difficulty breathing.
  - You feel dizzy or are in pain.
  - Your mask is damaged.
  - There is an emergency.

## Disposal

The mask should be disposed of as solid waste.

## General

The wearer must comply with guidelines provided in this manual concerning the use and storage of this mask. Scandia Gear is not liable for injuries or damages, in any form, that result from use or misuse.

## Statutory Stipulations and Regulations

### Regulation (EU) 2016/425

Regulation (EU) 2016/425 of the European Parliament and Council relating to Personal Protective Equipment Regulation (PPE)

### EN 143:2000/A1:2006

Particle filters : requirements, testing, marking

### EN standard 149:2001+A1:2009

Filtering half masks for particle protection

### EC type investigation

BSI

### Monitoring of Manufactured PPE (according to Module D)

BSI

### Identification number

2797

### Official marks

CE 2797

### Australian / New Zealand standards

AS/NZS 1716:2012

# SCANRESPI FFP

## Half Mask Respirator

## User's Instruction