

1. Installation and operation

Place the bracket under the lifejacket's fixing band, then insert the bracket into the holes on the back of the light to attach the light to the life-jacket.

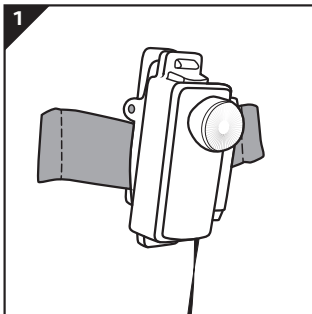

2. To switch on

Use the rope connected to the push-pull switch to activate the light

(i.e., move it to the "ON" position).

Now on standby, the light will brighten and flash automatically when in contact with water.

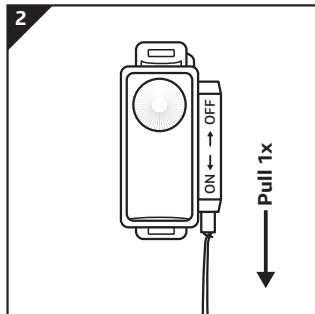

3. To switch off

Use the rope connected to the push-pull switch to deactivate the light.

(i.e., move it to the "OFF" position).

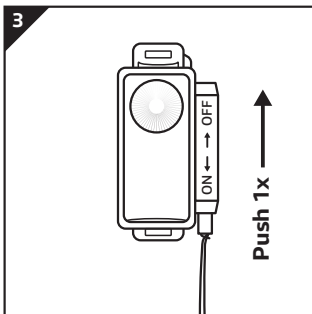

4. Automatic activation

To activate the automatic setting, switch the light on and off twice in 2 seconds.

The light will brighten and flash automatically. In addition, this function can be used to check battery power. If the battery charge indicator's light is red, the battery is fully charged.

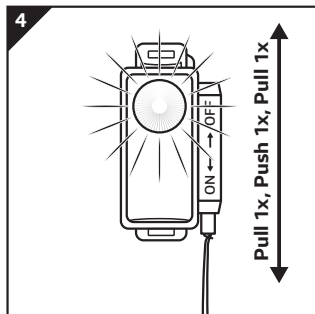

General

Scandia Gear's lifejacket light is equipped with an Energizer CR2 lithium battery and a white LED bulb powered by a direct current (DC) and controlled by a microchip embedded in the device. The light is compact, dependable, safe to use, easy to attach to lifejackets, and operates on minimal power.

The light's push-pull switch allows the user to adjust settings and check battery power.

Warning!

THE SC-LG4 lifejacket light contains a lithium battery and components that must be handled with care:

- Do not dismantle the battery pack
- Do not incinerate the device or its components
- Do not connect the device to any external power sources
- Store between -30°C - 65°C / -22°F - 149°F
- Do not recharge the battery
- Dispose of the battery, light, and the light's components in accordance with local regulations

Luminous Intensity	≥ 0,75 cd	Adaptive surrounding temperature	-30°C - 65°C -22°F - 149°F
Duration	≥ 8 Hours	Operating temperature	-15°C - 40°C 5°F - 104°F
Battery used	CR2 Lithium Battery	Light type	Flash
Lamp house	LED	Flame color	White
Validity	EC / 5 Years	Flash frequency	50 - 70 Times / Min